



LG ipsolute

# LG MEGAPIXEL IP CAMERA

DELIVERS SUPERIOR RESOLUTION



| IP DOME CAMERA |

LND3100

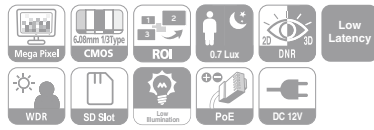

**Features**

- 6.08 mm (1/3 type) CMOS
- 3 mm F2.0
- 30 fps @ 1280 x 1024, 720p(HD)
- Min. Illumination
  - Color : 0.7 Lux @ F2.0
  - B/W : 0.7 Lux @ F2.0
- H.264 (High Profile Supported) / MJPEG
- 80dB of Wide Dynamic Range
- 2D+3D DNR
- Digital Day & Night
- Dynamic Profile (Up to 7)
- Region Of Interest Streaming
- LG Ipsolute VMS, Mobile App
- Micro SD Slot
- PoE / DC12V

**Rear View (World Wide Type)**



**Dimension (Unit : mm)**

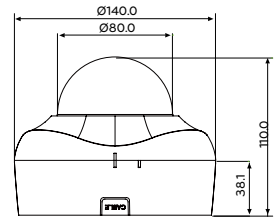

Model		LND3100
Camera	Image Sensor	6.08mm (1/3 Type) CMOS
	Lens	3mm F2.0
	Resolution	Up to 1280 x 1024
	Min. Illumination	Color : 0.7 Lux @ F2.0 B/W : 0.7 Lux @ F2.0
	Day / Night	Digital (Auto / Day / Night)
	WDR	80 dB
Video/Audio	Image Enhancement	Backlight Compensation / 2D+3D-DNR / Exposure Control / Sens-up Control / AGC / White Balance / Privacy Masking / EIS / Sharpness / Digital Zoom
	Video Compression	H.264 (High Profile Supported) / MJPEG
	Frame Rate	30 fps @ 1280 x 1024, 30fps @ 720p(HD)
	Multi-Streaming	Dynamic Profile (Up to 7)
	ROI Streaming	Yes
Event	Open Protocol	ONVIF 1.02, PSIA 1.1
	Motion Detection	Yes
	Event Notification	Email, FTP
Interface	Pre/Post Event Buffering	5 / 5 Seconds
	Video In / Out	1 RCA Out
Network	SD Slot	Micro SD
	Ethernet	RJ-45 10/100 BASE-T
	Security	Password Protection, HTTPS (SSL, TLS)
	Protocol	IPv4/6 - TCP/IP, UDP, HTTP, HTTPS, RTP, RTSP, DHCP, ICMP, IPv4 - FTP, SMTP, NTP, ARP, SNMP v1/v2c/v3, DDNS (LG)
	Web Viewer	Microsoft Internet Explorer 7.0 or above
	Video Management Software	LG Ipsolute VMS, Mobile Application
	Connections	Up to 10
General	Power Source	PoE / DC12V
	Power Consumption	5.9 W
	Operating Temperature / Humidity	-10°C ~ 50°C / 0% ~ 80%RH
	Standard Approvals	UL, FCC, CE, KCC, Gongan
	Color / Material	White / Plastic
	Ingress Protection	-
	Dome Cover	Clear type
	3-Axis	Yes
	Dimension (Ø x H) mm	140 x 110
	Weight	506 g

\* Exact products and specifications shown may vary by geographic region and are subject to change without notice. Actual products may differ from the images appearing in the catalog.

**SECURITY OVERSEAS MARKETING TEAM**

LG Twin Towers, 20 Yeouido-dong, Yeongdeungpo-gu, Seoul 150-721, Korea

Phone : +82-2-3777-5184 Fax : +82-2-3777-5185

[www.LGsecurity.com](http://www.LGsecurity.com)



The eco-friendly label is attached to those products which have passed LG Electronics' rigorous environmental criteria that evaluate 6 hazardous materials (lead, mercury, cadmium, etc.)





## IP CAMERA TERMS & FEATURES



LG Ipsolute refers to the route that provides solutions alongside IP products as the integrated brand of LG security network products. LG Ipsolute IP camera and server can easily connect to the Internet, use diverse compression methods, and transmit HD images at low beat ratio without loss. In addition, the network security system is implemented by the basic web viewer, mobile applications, and video management suite enabling remote control and monitoring.



### LOW ILLUMINATION

Low luminance noise is excellent with XDI-II

1 Lux

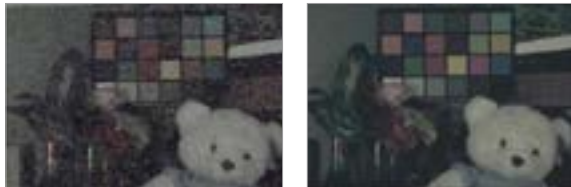

Conventional

LG



### LOW LATENCY

Possesses excellent network performance with almost no latency, compared to the other products

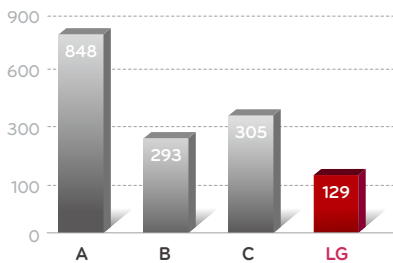

### SD SLOT

we provide SD SLOT for video buffering and backup event video separately. (SD Memory chip is not included)



### SENS-UP / EIS / 3D-DNR

XDI-II can process Full HD superior images and apply WDR, Sens-up, EIS, and 3D-DNR functions.

#### | SENS-UP |

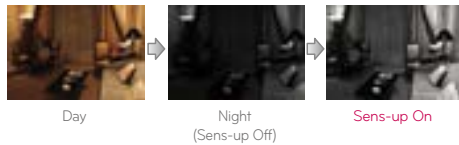

#### | EIS |

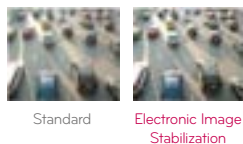

#### | 2D+3D-DNR |

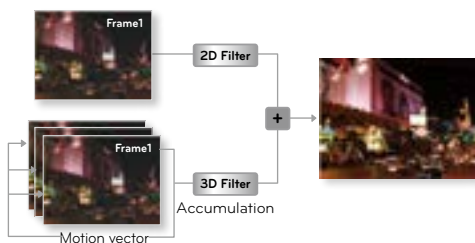

### LOW INSTALLATION COST WITH PoE

Power over Ethernet (PoE) refers to a technology that allows IP devices to receive power over existing LAN cabling. PoE does not need any separate power installation connection and thus simplifies installation. The technology is space-saving and allows devices to receive power and data over existing infrastructures, without needing to upgrade them.

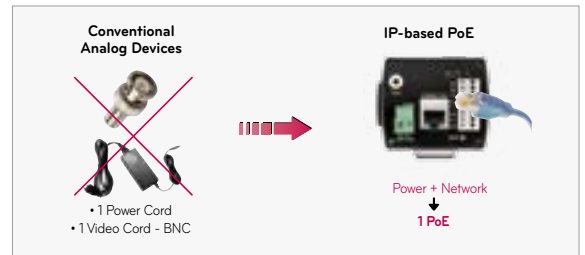

### 80DB WDR

XDI-II offers 80dB of Dynamic Range and creates nearly no noise, enabling users to better see objects even with backlight.

WDR	LG		Other Camera	
	off	on	off	on
Detected zones<0.98	23	40	22	34.8
DR (f-stops)	7.83	13.3	7.37	11.6
DR (dB)	47.1366	80.066	44.3674	69.832

WDR OFF

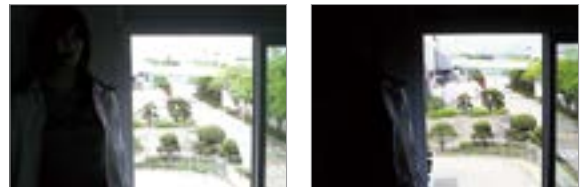

WDR ON



Conventional

LG



### LG IPSOLUTE VMS / MOBILE APPLICATION

The LG Video Management System is an IP-Surveillance software that works with the LG Video Server and LG IP cameras to provide video monitoring, recording setting and event management functions.

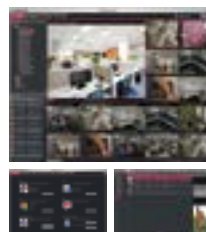

VMS

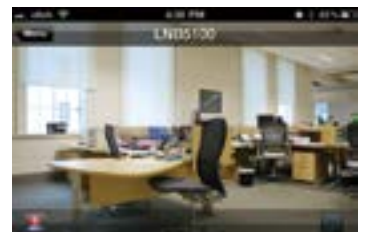

Mobile Application